



THE
DRAPERS'
HALL

WELCOME TO DRAPERS' HALL, TRULY ONE OF THE MOST MAGNIFICENT VENUES IN LONDON.

The Drapers' Company is a grant-making body, dedicated to the art of giving. We take great pride in owning an important historic building and delight in sharing it with others. In fact, we've been entertaining people on our present site for 500 years. We hope you'll give us the opportunity to show you what Drapers' hospitality looks like today.

WHY CHOOSE DRAPERS' HALL FOR YOUR EVENT?

Drapers' Hall boasts magnificent interiors creating a stunning backdrop to every occasion.

The venue can comfortably hold up to 700 guests for a standing reception when using all rooms, 276 for a seated dinner and 300-350 for theatre style presentations or concerts. This makes Drapers' Hall the perfect location for all types of events. Our exquisite in-house catering, and the service provided by our experienced and dedicated team, will ensure that your event is perfect in every way.



COURT DINING ROOM

THE COURT DINING ROOM IS A FAVOURITE PLACE FOR INTIMATE LUNCHEES AND CANDLELIT DINNERS. IT OVERLOOKS OUR HISTORIC GARDEN AND IS NEXT TO THE DRAWING ROOM WITH WHICH IT CAN BE COMBINED FOR LARGE RECEPTIONS.

This room stands in the oldest part of Drapers' Hall dating to the late 1660s though altered in 1869 by John G Crace whose family worked for every British monarch from George III to Queen Victoria. Its focal point is a portrait of Queen Elizabeth II who became a Draper in 1947, and whatever happens here, time is history, measured by a clock of 1715 by the celebrated Daniel Quare.

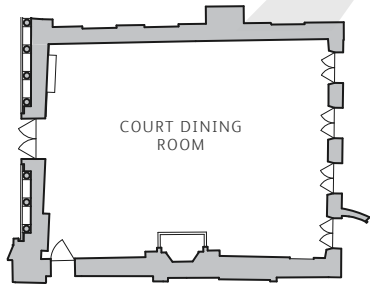
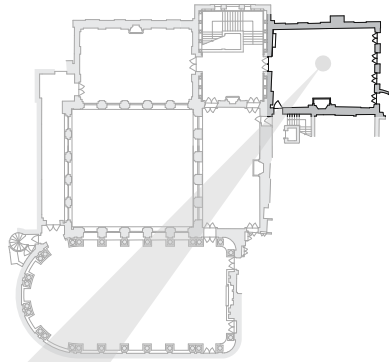

THE SPECIFICATIONS

LENGTH 12.4M
WIDTH 9.5M

Please note that all room layouts are based on the maximum capacity so a reduction should be taken into consideration if staging, or screen and projection is required.



STANDING
120



BANQUET
96



THEATRE
100



CABARET
56



THE DRAPERS' COMPANY
TAKES GREAT PRIDE AND
CARE IN PROVIDING
WORLD CLASS CATERING
FOR ALL GUESTS AT
THE HALL.

DRAWING ROOM

AN ELEGANT SETTING FOR CHAMPAGNE RECEPTIONS, AND LARGE AND LIGHT ENOUGH TO BE A FILM-MAKERS HEAVEN, THE DRAWING ROOM IS HUNG WITH DELICATE VICTORIAN CHANDELIERS AND RETAINS ITS ORIGINAL PALE GREEN AND CREAM COLOUR SCHEME OF THE 1860s.

It is also a good setting for presentations with sculpture busts of Queen Elizabeth II and HM The King, both members of the Drapers' Company, lending it appropriate formality.

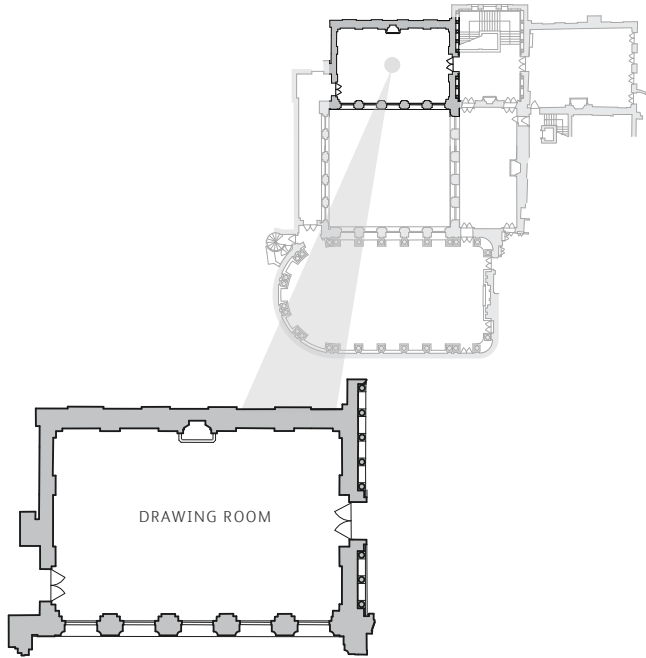

THE SPECIFICATIONS

LENGTH 13.4M
WIDTH 8.4M

Please note that all room layouts are based on the maximum capacity so a reduction should be taken into consideration if staging, or screen and projection is required.



STANDING
120



THEATRE
100



CABARET
56



IT WAS AN ABSOLUTELY
OUTSTANDING
EVENING AND WAS SO
WELL RECEIVED.
LONDON PRISON AWARDS

COURT ROOM

THE COURT ROOM LENDS ITSELF TO AN ARRAY OF EVENTS AND IS THE PERFECT SIZE FOR BREAKFASTS, INFORMAL LUNCHES AND BREAKOUT SPACE AT CONFERENCES.

Louis XIV tapestries, 18th century chandeliers and portraits of The Duke of Wellington and Lord Nelson lend gravitas to this important room. Connecting as it does directly to the Livery Hall, also makes it much in demand for dancing, for which we have our own dancefloor.

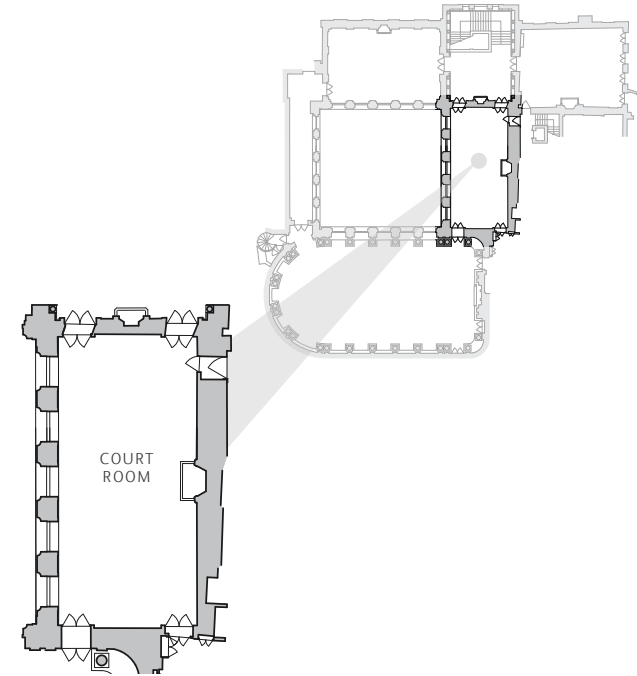

THE SPECIFICATIONS

LENGTH 14.6M
WIDTH 6.9M

Please note that all room layouts are based on the maximum capacity so a reduction should be taken into consideration if staging, or screen and projection is required.



STANDING
100



BANQUET
60



THEATRE
80



CABARET
35



DRAPERS' HALL OFFERS COMPLETE EXCLUSIVITY FOR EVENTS, MAKING IT A FANTASTIC CHOICE FOR WEDDING RECEPTIONS AND SPECIAL EVENTS.

LIVERY HALL

THE DRAPERS' LIVERY HALL IS ONE OF THE FINEST GRAND ROOMS ANYWHERE IN LONDON. FROM BANQUETS, WEDDINGS, FASHION SHOWS, COCKTAIL PARTIES, CONCERTS AND OPERA RECITALS TO CONFERENCES AND PRESENTATIONS, IT IS LARGE AND VERSATILE ENOUGH TO ACCOMMODATE ALMOST ANYTHING YOU HAVE IN MIND.

The vast ceiling is adorned with scenes from Shakespeare's plays 'The Tempest' and 'Midsummer Night's Dream' and around the walls we display some of our finest silver. Marble-columned, galleried, gilded and hung with royal portraits, this is where members of the royal family and other heads of state have dined. No surprise then, that it has appeared on television as Buckingham Palace.

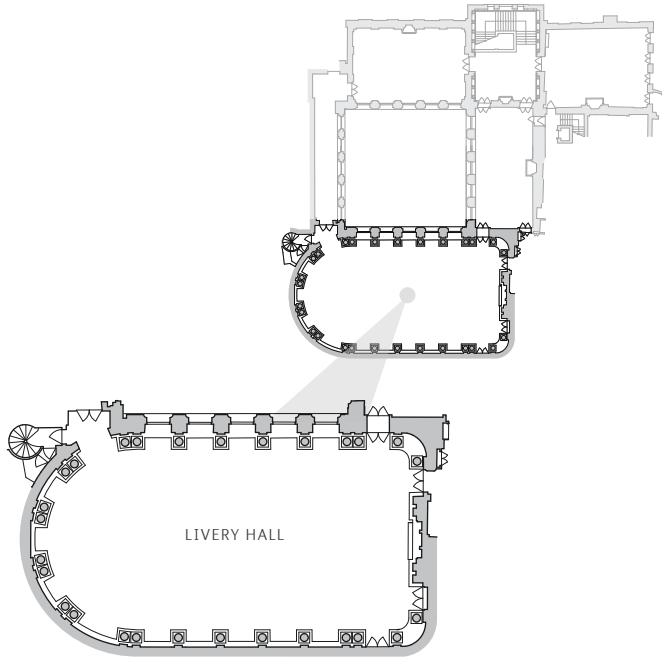

THE SPECIFICATIONS

LENGTH 23M
WIDTH 11.8M

Please note that all room layouts are based on the maximum capacity so a reduction should be taken into consideration if staging, or screen and projection is required.



STANDING
450



BANQUET
276



THEATRE
350



CABARET
140



A GREAT EVENT AS USUAL
AND PLEASE PASS OUR
THANKS ON TO THE WHOLE
TEAM AT DRAPERS' HALL.
BRITISH PORTS ASSOCIATION

THE DRAPERS' HALL GARDEN AND COURTYARD

WHERE ONCE THOMAS CROMWELL, WHOSE MANSION STOOD ON OUR CURRENT SITE, STROLLED THROUGH ROSE BUSHES, FRUIT TREES AND HERB BEDS, YOUR GUESTS CAN ENJOY A HIDDEN OASIS IN THE HEART OF LONDON.

Much has changed since Cromwell's day but with mulberry trees, a water feature and flowers reflecting the azure and gold of the Drapers' Company coat of arms, our garden retains its sense of history.

The Drapers' Hall Garden is perfect for entertaining guests on warm evenings, comfortably holding up to 180 people for a drinks reception.

The Courtyard provides another separate outdoor space for evening receptions at Drapers' Hall, completely independent from the beautiful Drapers' Hall Garden.

Though now boasting 19th century Portland stone arches, the courtyard is still at the heart of Drapers' Hall today. It can be used on its own or in conjunction with the garden for larger outdoor events and can accommodate up to 150 guests for a drinks reception.



THERE HAVE BEEN MULBERRY TREES IN THE DRAPERS' HALL GARDEN SINCE THE TIME OF KING JAMES I. OF TODAY'S TREES, ONE WAS PLANTED BY HM THE KING IN 1971

BANQUETING & PRIVATE EVENTS

FORMAL BANQUETS, DINNER AND DANCING, FASHION SHOWS, COCKTAIL PARTIES, MUSICAL EVENINGS, CELEBRATORY LUNCHEES AND DISCRETE PRIVATE SOIREEES: DRAPERS' HALL WAS DESIGNED FOR ENTERTAINING.

Our Livery Hall is known as one of the most impressive in the City, so is our catering team. Our reception rooms and outside spaces are flexible, and our in-house events team like to make all things possible.



CORPORATE EVENTS

OUR MANY DIFFERENT SPACES ACCOMMODATE CONFERENCES, AGMS, SEMINARS, EXHIBITIONS AND TRADE FAIRS.

With a built-in lighting and sound system, Drapers' Hall is well equipped to accommodate conferences, AGMs, seminars, exhibitions and product launches, offering corporate clients something that is very different to the purpose-built conference facility; a magnificent and accommodating location full of character, charm and rich history that will leave a lasting impression on guests.



THE FOOD WAS SUPERB. ALL IN ALL, PROBABLY OUR MOST SUCCESSFUL PARTY, AND IN A STUNNING VENUE!

CHARLES TAYLOR PLC

WEDDING RECEPTIONS

AT DRAPERS' HALL YOU ARE MARRYING INTO 500 YEARS OF HISTORY.

Our experienced in-house team and gold medal-winning chef will be at your service. Every wedding is unique, and Drapers' Hall offers complete flexibility and exclusivity for wedding couples, with bespoke catering options and inclusive wedding packages that can be tailored to your taste.

Couples that choose Drapers' Hall for their wedding reception will benefit from an incredibly simple planning process, with all the essentials included, plus elegant candelabra table centres, dance floor and a Steinway classic grand piano. Our Events team will help you at every stage to plan your day and ensure that every detail is perfect for you.

Whether Drapers' Hall is chosen to host a small intimate wedding breakfast or the grandest of celebrations, the venue is available for your exclusive use, including our two outdoor spaces, meaning your special day does not have to be shared with anyone else but your guests.



“ONCE AGAIN, THANKS FOR ALL
YOUR HARD WORK, AND ALL
THE STAFF AT THE HALL WHO
MADE THE DAY A PERFECT ONE...
THE FOOD, THE SERVICE, THE
PLANNING AND PREPARATION, WE
COULD NOT FAULT ANYTHING”

NICK AND VICTORIA (WEDDING)

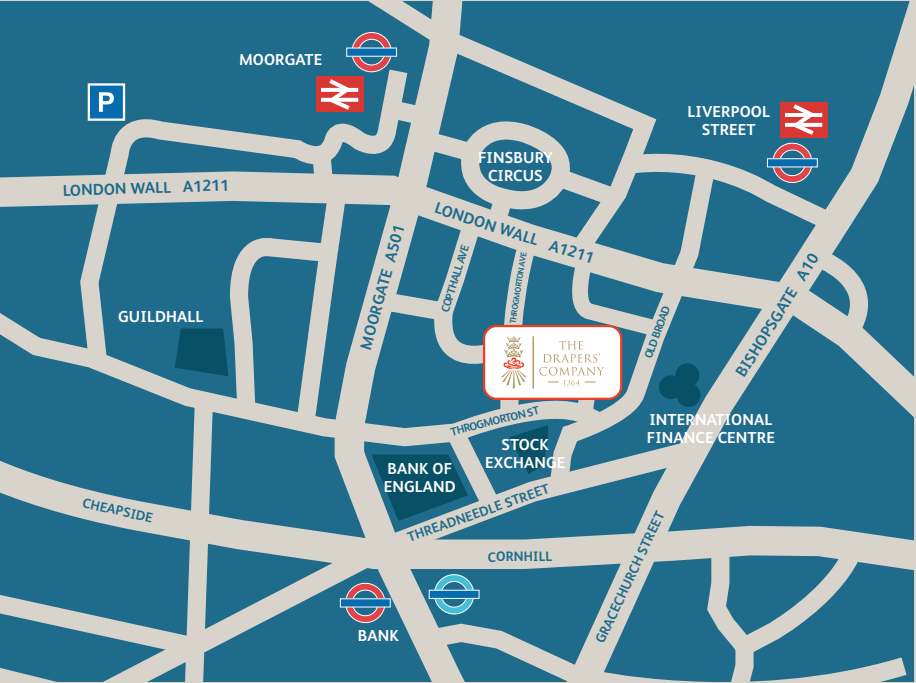

LOCATION

Nearest Tube: Bank / Liverpool Street / Moorgate
Nearest Rail Stations: Liverpool Street / Moorgate

NEAREST PARKING

There are two NCP car parks situated near to Drapers' Hall, one in Finsbury Square and the other near London Wall. There are also parking meters in Finsbury Circus.

TOURS

Tours of Drapers' Hall for groups can be arranged by appointment. The maximum size per group is 50. There is no formal charge for tours, but visitors are asked to make a donation to the Drapers' Charitable Fund. Individuals can apply to join a pre-arranged Hall tour by contacting the Events Team.

CONTACT

Events and Catering Team
Drapers' Hall,
Throgmorton Avenue
London EC2N 2DQ

Main Entrance for Events
Drapers' Hall,
Throgmorton Street
London EC2N 2AN

Telephone
Events - 020 7448 1324
Switchboard - 020 7588 5001

Email
events@thedrapers.co.uk

Website
www.thedrapers.co.uk

Social Media
 drapershallevents

datumcp.com 1202357

